

<b>PLAN OF SUBDIVISION</b>	LRS USE ONLY <b>EDITION</b>	PLAN NUMBER <b>PS631588R</b>	
<p>LOCATION OF LAND</p> <p>PARISH: PHILLIP ISLAND AT COWES</p> <p>TOWNSHIP: —</p> <p>SECTION: —</p> <p>CROWN ALLOTMENT: 18 (PART)</p> <p>CROWN PORTION: —</p> <p>TITLE REFERENCE: VOL.11299 FOL.057</p> <p>LAST PLAN REFERENCE: LOT A ON PS631587T</p> <p>POSTAL ADDRESS: 144 VENTNOR ROAD (at time of subdivision) COWES 3922</p> <p>M.G.A. CO-ORDINATES E 344 900 ZONE: 55 (of approx. centre of land in plan) N 5 741 400</p> <p>VESTING OF ROADS AND / OR RESERVES</p>		<p>COUNCIL CERTIFICATION AND ENDORSEMENT</p> <p>COUNCIL NAME: BASS COAST SHIRE COUNCIL REF: 6001000706</p> <p>1. This plan is certified under section 6 of the Subdivision Act 1988.</p> <p>2. <del>This plan is certified under section 11(7) of the Subdivision Act 1988.</del> <del>Date of original certification under section 6 /</del></p> <p>3. <del>This is a statement of compliance issued under section 21 of the Subdivision Act 1988.</del></p> <p><u>OPEN SPACE</u></p> <p>(i) A requirement for public open space under section 18 of the Subdivision Act 1988 has <del>not been</del> made.</p> <p>(ii) <del>The requirement has been satisfied.</del></p> <p>(iii) <del>The requirement is to be satisfied in Stage.....</del></p> <p>Council Delegate <i>Sean O'Connor</i> <del>Council Seal</del></p> <p>Date <b>23/04/2012</b></p> <p><del>Re-certified under section 11(7) of the Subdivision Act 1988:</del></p> <p><del>Council Delegate</del> <del>Council Seal</del></p> <p><del>Date / /</del></p>	
<p>IDENTIFIER</p> <p>ROAD R1</p> <p>RESERVE No.1</p>		<p>NOTATIONS</p> <p>STAGING THIS IS NOT A STAGED SUBDIVISION. PLANNING PERMIT No. 040248</p> <p>DEPTH LIMITATION DOES NOT APPLY.</p> <p>LOT NUMBERS 1 TO 191 (BOTH INCLUSIVE) &amp; 219 TO 420 (BOTH INCLUSIVE) HAVE BEEN OMITTED FROM THIS PLAN.</p> <p>FOR THE RESTRICTIONS AFFECTING LOTS 202 TO 207 (BOTH INCLUSIVE) SEE THE CREATION OF RESTRICTION ON SHEET 4.</p> <p>THE LAND BEING SUBDIVIDED IS ENCLOSED WITHIN THICK CONTINUOUS LINES.</p> <p>SURVEY THIS PLAN IS BASED ON SURVEY.</p> <p>THIS SURVEY HAS BEEN CONNECTED TO PERMANENT MARKS No.(s) — IN PROCLAIMED SURVEY AREA No. —</p>	
<b>EASEMENT INFORMATION</b>			
<p>LEGEND: E - ENCUMBERING EASEMENT OR CONDITION IN CROWN GRANT IN THE NATURE OF AN EASEMENT A - APPURTENANT EASEMENT R - ENCUMBERING EASEMENT (ROAD)</p>			
SUBJECT LAND	PURPOSE	WIDTH (METRES)	ORIGIN
E-1	DRAINAGE	SEE DIAG.	PS631586V
E-1	SEWERAGE	SEE DIAG.	PS631586V
E-2	DRAINAGE	SEE DIAG.	PS631587T
E-2	SEWERAGE	SEE DIAG.	PS631587T
E-3	DRAINAGE	SEE DIAG.	THIS PLAN
E-3	SEWERAGE	SEE DIAG.	THIS PLAN
		LAND BENEFITED/IN FAVOUR OF	
		BASS COAST SHIRE COUNCIL	
		WESTERNPORT REGION WATER CORPORATION	
		BASS COAST SHIRE COUNCIL	
		WESTERNPORT REGION WATER CORPORATION	
		BASS COAST SHIRE COUNCIL	
		WESTERNPORT REGION WATER CORPORATION	

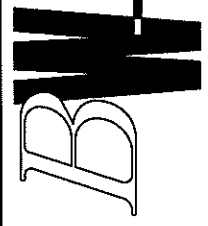

**Beveridge Williams**  
development & environment consultants  
Melbourne ph : 03 9528 4444  
www.beveridgewilliams.com.au

LICENSED SURVEYOR (PRINT) SEAN ADRIAN O'CONNOR  
SIGNATURE *Sean O'Connor* DATE: 18/11/2011  
REF. 4015/7 VERSION 6

LRS USE ONLY

STATEMENT OF COMPLIANCE/ EXEMPTION STATEMENT

RECEIVED

DATE / /

LRS USE ONLY

PLAN REGISTERED

TIME / /

DATE / /

Assistant Registrar of Titles

SHEET 1 OF 4 SHEETS

*Sean O'Connor*

DATE **23/04/2012**

COUNCIL DELEGATE SIGNATURE

ORIGINAL SHEET SIZE A3

# PLAN OF SUBDIVISION

STAGE No. /

PLAN NUMBER  
**PS631588R**

## KEY DIAGRAM

FOR LOTS 192 TO 218 (BOTH INCLUSIVE),  
421, ROAD R1, RESERVE No.1 &  
EASEMENTS SEE SHEET 3

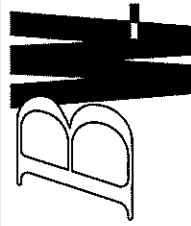
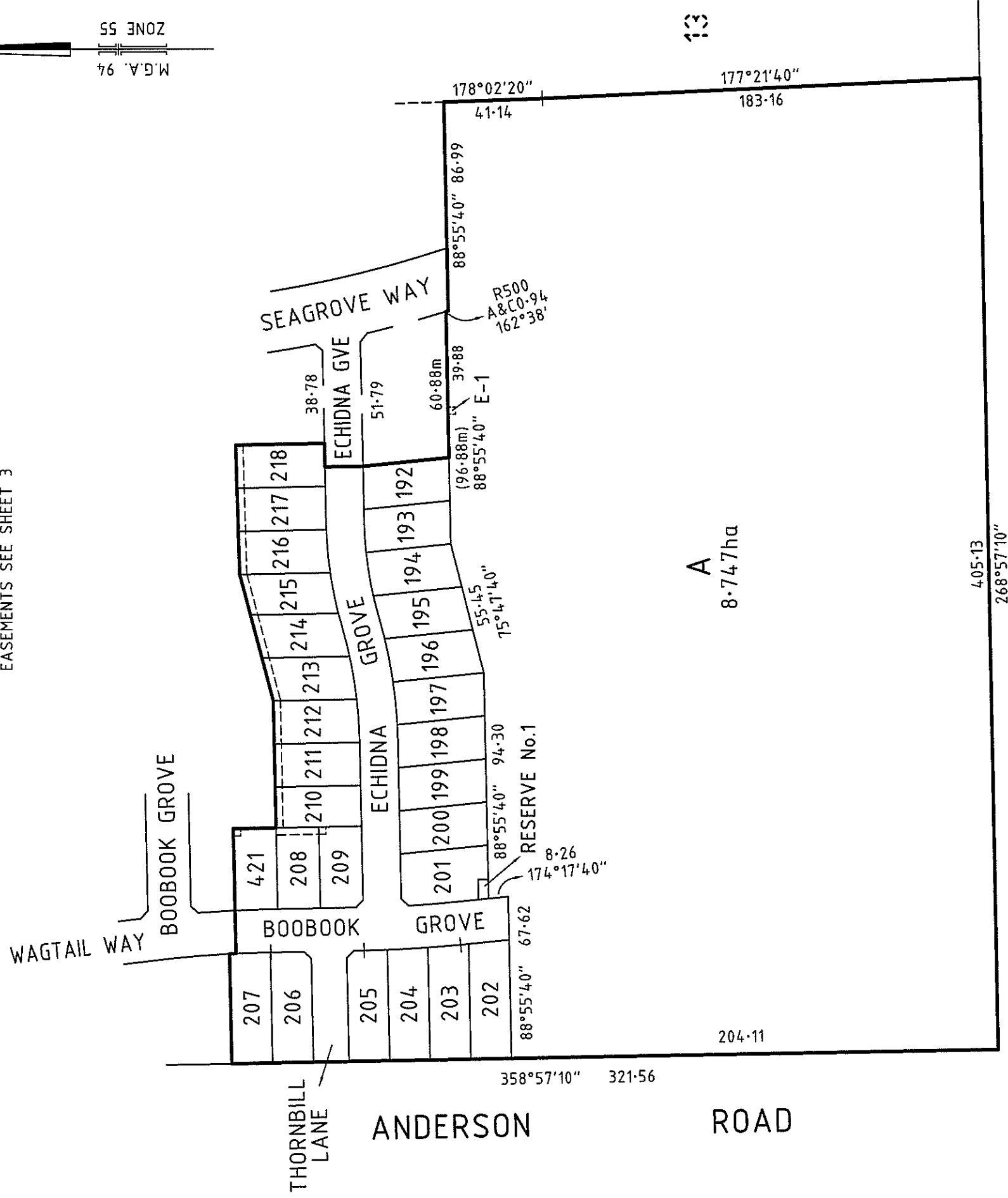

**Beveridge Williams**  
development & environment consultants

Melbourne ph : 03 9528 4444

www.beveridgewilliams.com.au

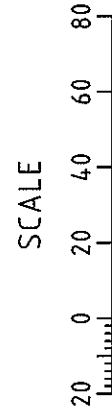

ORIGINAL	SHEET
SCALE	SIZE
1:2000	A3

LICENSED SURVEYOR (PRINT) SEAN ADRIAN O'CONNOR  
SIGNATURE *[Signature]* DATE: 18/11/2011  
REF 4015/7 VERSION 6

SHEET 2

DATE 23/04/2012  
COUNCIL DELEGATE SIGNATURE *[Signature]*

# PLAN OF SUBDIVISION

STAGE No. /

PLAN NUMBER

## PS631588R

### BOOBOOK GROVE

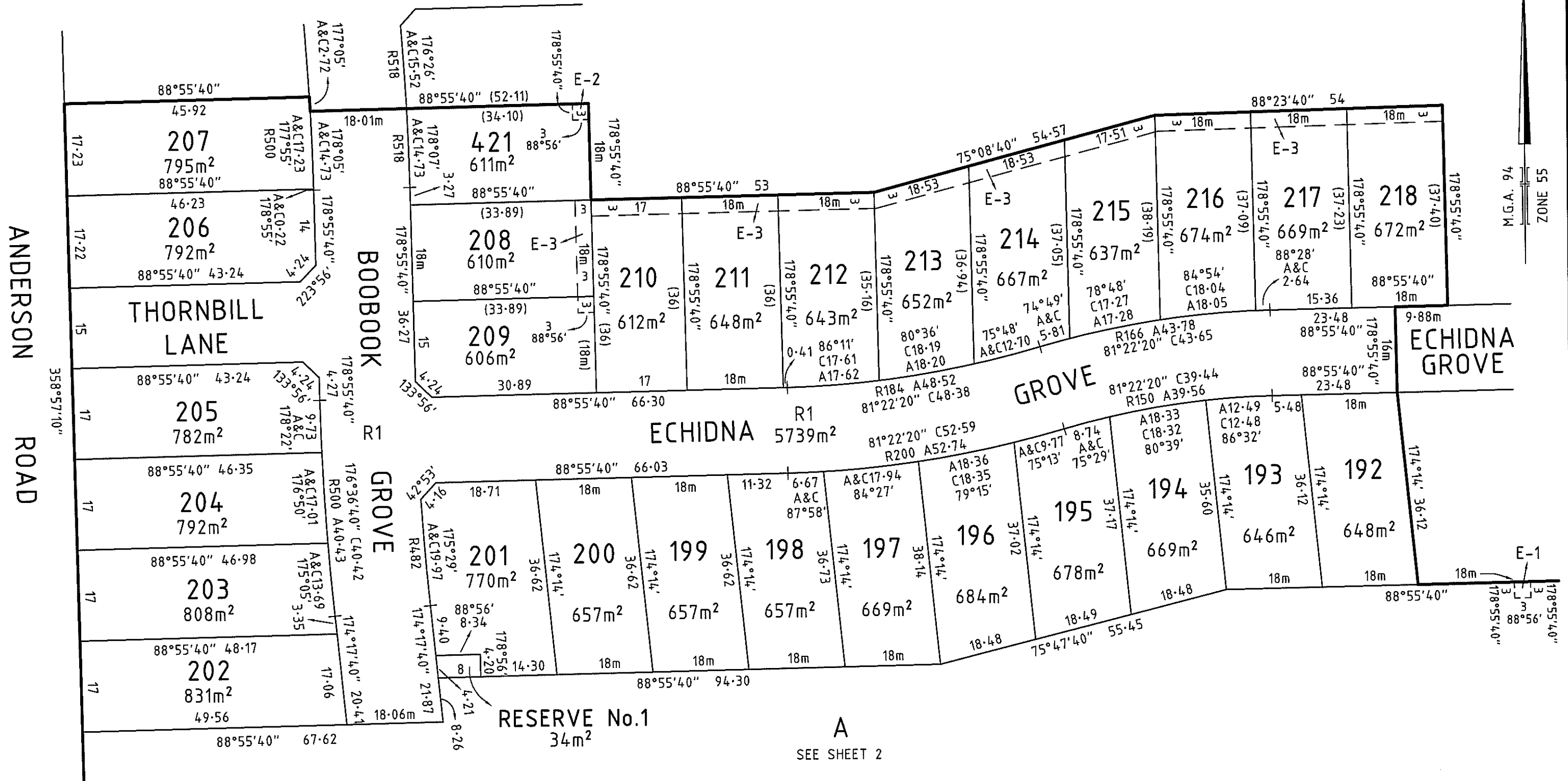

ANDERSON ROAD

THORNBILL LANE

BOOBOOK GROVE

ECHIDNA GROVE

ECHIDNA GROVE

RESERVE No.1  
34m²

A  
SEE SHEET 2

**Beveridge Williams**  
development & environment consultants  
Melbourne ph : 03 9528 4444  
www.beveridgewilliams.com.au

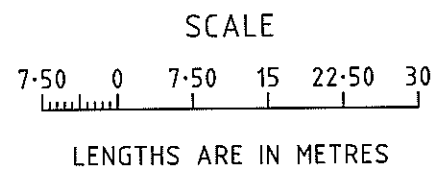

ORIGINAL SCALE SHEET SIZE  
1:750 A3

LICENSED SURVEYOR (PRINT) SEAN ADRIAN O'CONNOR  
SIGNATURE *[Signature]* DATE: 18/11/2011  
REF 4015/7 VERSION 6

SHEET 3  
DATE 23/04/2012  
COUNCIL DELEGATE SIGNATURE

**PLAN OF SUBDIVISION**

STAGE No.

PLAN NUMBER

**PS631588R**

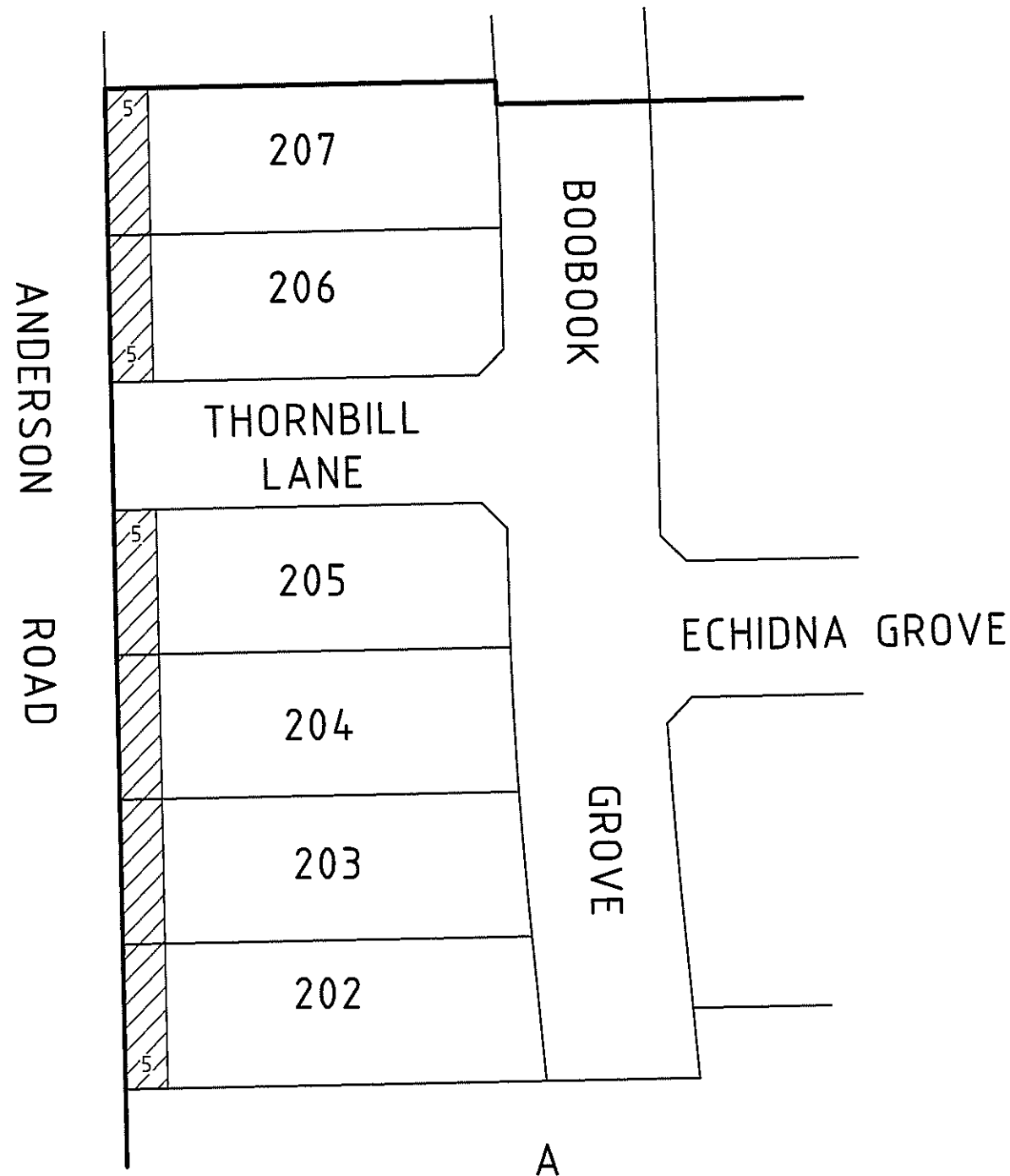

CREATION OF RESTRICTION

UPON REGISTRATION OF THIS PLAN THE FOLLOWING RESTRICTION IS CREATED.

LAND TO BENEFIT : LOTS ON THIS PLAN.

LAND TO BE BURDENED : LOTS 202 TO 207 (BOTH INCLUSIVE)

DESCRIPTION OF RESTRICTION

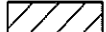
EXCEPT WITH THE WRITTEN CONSENT OF THE BASS COAST SHIRE COUNCIL THE REGISTERED PROPRIETOR OR PROPRIETORS FOR THE TIME BEING OF LOTS 202 TO 207 (BOTH INCLUSIVE) ON THIS PLAN SHALL NOT PLACE, CONSTRUCT, ALLOW TO BE PLACED OR ALLOW TO BE CONSTRUCTED ANY BUILDING OR STRUCTURE OTHER THAN A FENCE WITHIN THE LAND SHOWN THUS  ON THE DIAGRAM.



**Beveridge Williams**  
development & environment consultants

Melbourne ph : 03 9528 4444

www.beveridgewilliams.com.au

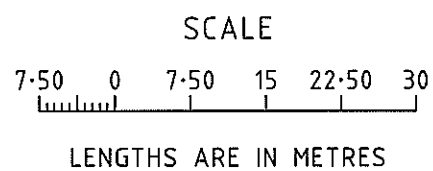

ORIGINAL SCALE 1:750  
SHEET SIZE A3

LICENSED SURVEYOR (PRINT) SEAN ADRIAN O'CONNOR  
SIGNATURE  DATE: 18/11/2011  
REF 4015/7 VERSION 6

SHEET 4  
  
DATE 23/04/2012  
COUNCIL DELEGATE SIGNATURE