

NOTE:
ALL PROPERTY SERVICE CONNECTIONS
(DRY TAPPINGS) ARE TO BE INSTALLED
ACCORDING TO WESTERNPORT WATER
SPECIFICATIONS.

LEGEND

SEWER MAIN ————●———■———

STORMWATER DRAIN (PROPOSED) - - - - -

VALVE ⊗

FIREPLUG ⊙

TAPER ▸

TAPPING UNDER PRESSURE - T.U.P.

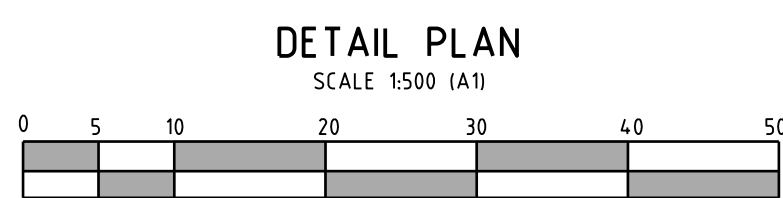

Revision	Details	Date	App'd
E	WESTERPORT WATER AMENDMENTS	13/9/11	PW
D	LOT NUMBERS AMENDED	9/8/11	PW
C	LOTS 204 AND 205 ROTATED	12/7/11	PS
B	100 DIA MAIN UPSIZED TO 225 DIA	4/10/10	PS

BW BEVERIDGE
WILLIAMS & CO.
SURVEYORS
ENGINEERS
ENVIRONMENTAL
CONSULTANTS
PO BOX 2295 CAULFIELD
JUNCTION 381 9206444
BW REF: E4015/1

WESTERPORT WATER
Trading name for:
WESTERPORT REGION WATER AUTHORITY
2 Boys Home Road Newhaven 3925
Phone (03) 5952 2393 Fax (03) 5952 3115

Drawn	C. KIRKCALDY
Designed	P. SMITH
Checked	D. BELTON
Date	March 2009
Scale	As Shown

WESTERPORT WATER
SEAGROVE ESTATE STAGE 7, COWES
WATERMAIN DETAIL PLAN

DRG. NO.
W??
A1
sheet 2 of 2



Revision	Details	Date	App'd
E	WESTERNPORT WATER AMENDMENTS	13/9/11	CW
D	LOT NUMBERS AMENDED	9/8/11	PW
C	LOTS 204 AND 205 ROTATED	12/7/11	PS
B	NOTES ADDED & INVERT LEVELS AMENDED	4/10/10	PS

BW

Beveridge Williams

development & environment consultants

1 Glenferrie Road
Malvern VIC 3144
ph : 03 9524 8888
www.beveridgewilliams.com.au

© 2011
Beveridge Williams

WESTERNPORT WATER

Trading name for:
WESTERPORT REGION WATER AUTHORITY
2 Boys Home Road Newhaven 3925
Phone (03) 5952 2393 Fax (03) 5952 3115

WESTERNPORT WATER

Drawn	C. KIRKCALDY
Designed	P. SMITH
Checked	C. WHITE
Date	March 2008
Scale	As Shown

SEAGROVE ESTATE STAGE 7, COWES
SEWER DETAIL PLAN

DRG. NO.	A1
S??	
sheet 2 of 4	

LEGEND

PROPOSED TREES & SHRUBS

TERRESTRIAL PLANTING 1
(SHREDDED EUCAMULCH)

EPHEMERAL RAINGARDEN
PLANTING (TARRAWINGEE
PEBBLES' GRAVEL MULCH)

GRASS (SEEDED)

DRAINAGE

SERVICES

ELECTRICITY / STREET LIGHTS

STAGE 5 BOUNDARY

TIMBER EDGE

- GENERAL NOTES
1.

Refer to Landscape Specification by Beveridge Williams.
2.

The Landscape Contractor must refer to civil engineering drawings for set out of roads and carpark and all infrastructure.
3.

This plan is intended for soft landscaping and associated landscape materials and must not be used for any other purposes.
4.

All survey information supplied is assumed to be correct.
5.

The Landscape Contractor must verify all dimensions and areas prior to commencing any work or placing any orders for materials.
6.

The Landscape Contractor must determine the location of all underground services prior to commencing any work on site and shall be liable for any damage to services or conduits.
7.

The Landscape Contractor must immediately report any perceived errors or omissions in the landscape drawings to the Project Manager and Client.
8.

Where any conflict occurs between proposed tree locations and infrastructure, such as light poles or powerlines, tree(s) must be relocated or removed.
9.

The Landscape Contractor must confirm all plant quantities prior to ordering.
10.

Grassed nature strips as specified.
11.

Refer to Sheet 6/6 - LANDSCAPE DETAILS - for Establishment & Maintenance Notes
12.

Refer to Sheets 2-5/6 - LANDSCAPE PLANS - for Driveway Crossover and Timber Garden Edge notes

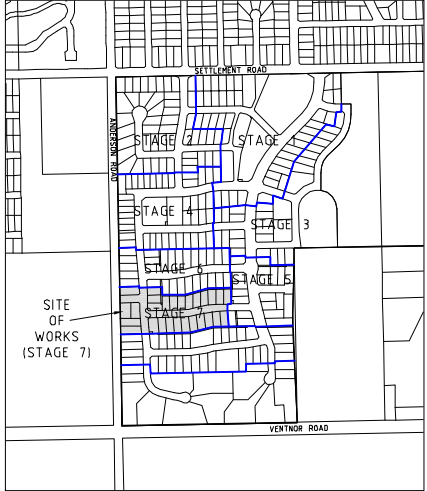

KEY PLAN (NOT TO SCALE)

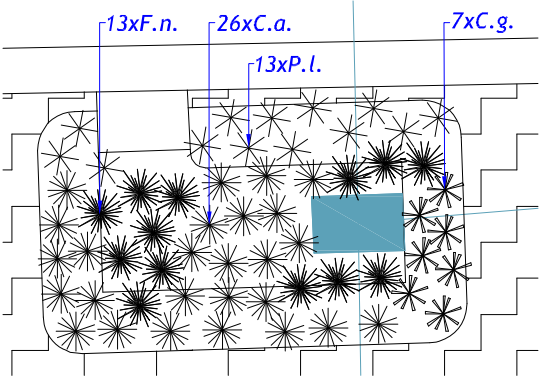

TYPICAL RAINGARDEN PLANTING DETAIL
SCALE 1:10 (A3) / 1:20(A1)

PLANT SCHEDULE						
CODE	BOTANICAL NAME	COMMON NAME	HEIGHT X WIDTH	% MIX & DENSITY	POT SIZE	QTY
Street Trees						
A.f.	Agonis flexuosa	Willow Myrtle	7-9x4-5m	-	400mm	15
A.m.	Acacia melanoxylon	Blackwood	12-16x5-7m	-	45L	9
A.v.	Allocasuarina verticillata	Drooping Sheoke	5-8x4-7m	-	45L	9
B.m.	Banksia marginata	Silver Banksia	2x1.8m	-	400mm	18
E.l.	Eucalyptus leucocylon 'Eukie Dwarf'	Dwarf Yellow Gum	9-10x7-9m	-	400mm	8
Terrestrial Planting 1 (Street planting) - Tussocks & groundcovers (total area 555m ²)						
D.r.	Dianella revoluta var brevicaulis	Black-anther Flax Lily	0.8x0.8m	-	Tube	162
F.n.	Ficinia nodosa	Knobby Club-Rush	1x0.8m	-	Tube	179
L.g.	Lepidosperma gladiatum	Coast Sward Sedge	1x1.5m	-	Tube	89
L.l.	Lomandra longifolia	Spiny Headed Mat Rush	1x1.2m	-	Tube	140
P.o.	Patersonia occidentalis	Purple Flag	0.3x0.5m	-	Tube	172
P.l.	Poa labillardieri	Common Tussock Grass	1x1m	-	Tube	143
Ephemeral Raingarden (total 136m ²)						
C.a.	Carex appressa	Tall Sedge	0.8X0.7m	22% @ 4/m ²	Tube	104
C.g.	Carex gaudichaudiana	Fen Sedge	0.8X0.5m	22% @ 4/m ²	Tube	28
F.n.	Ficinia nodosa	Hobby Club Rush	1x0.8m	44% @ 4/m ²	Tube	52
P.l.	Poa labillardieri	Common Tussock - Grass	0.8X0.8m	12% @ 4/m ²	Tube	52

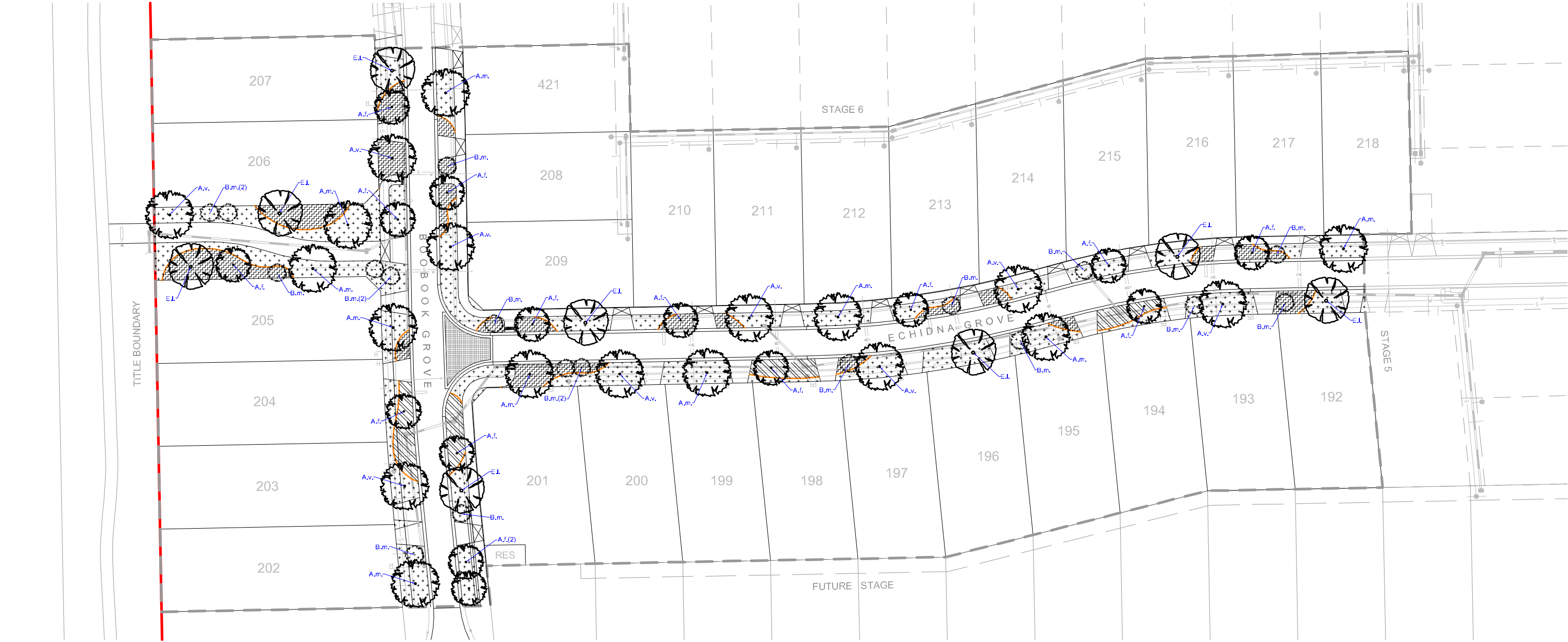

FOR COUNCIL APPROVAL

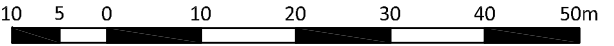

© COPYRIGHT
Beveridge Williams & Co Pty Ltd has granted a license to the
applicant to use this document for its intended purpose.
No unauthorized copying is permitted.

All rights reserved.

Client

SOUTHERN SUSTAINABLE
DEVELOPMENTS PTY LTD

Project Name

SEAGROVE ESTATE, STAGE-7
COWES

Drawing Title

LANDSCAPE PLAN

Designed date

N.VINCETT
23.11.11

Drawn

N.VINCETT

Approved date

H.VALENTINE
23.11.11

Beveridge Williams

development & environment consultants

1 Genferrie Road
Malvern VIC 3161
ph : 03 9524 8888
www.beveridgewilliams.com.au

Scale

1:800(A3)/1:400(A1)

Project Ref.

A4015-07

Drawing No.

1/6

Rev.

-

Drawing Ref.

K:\JOBS DATA\4015 - SEAGROVE ESTATE\LAN\A4015-SEAGROVE,
COWES\CAD\A4015-07 LP 20111122.DWG

Rev

Description

Date

By

App.

Rev

Description

Date

By

App.